

UNIT No.	TENANT	RENTABLE SQ. FT.	USABLE SQ. FT.
001	AVAILABLE	3,946	3,480
002	LION APPAREL	5,117	4,512
004	LION APPAREL	1,662	1,466
--	PARKING GARAGE	---	---
TOTAL		10,725	9,458

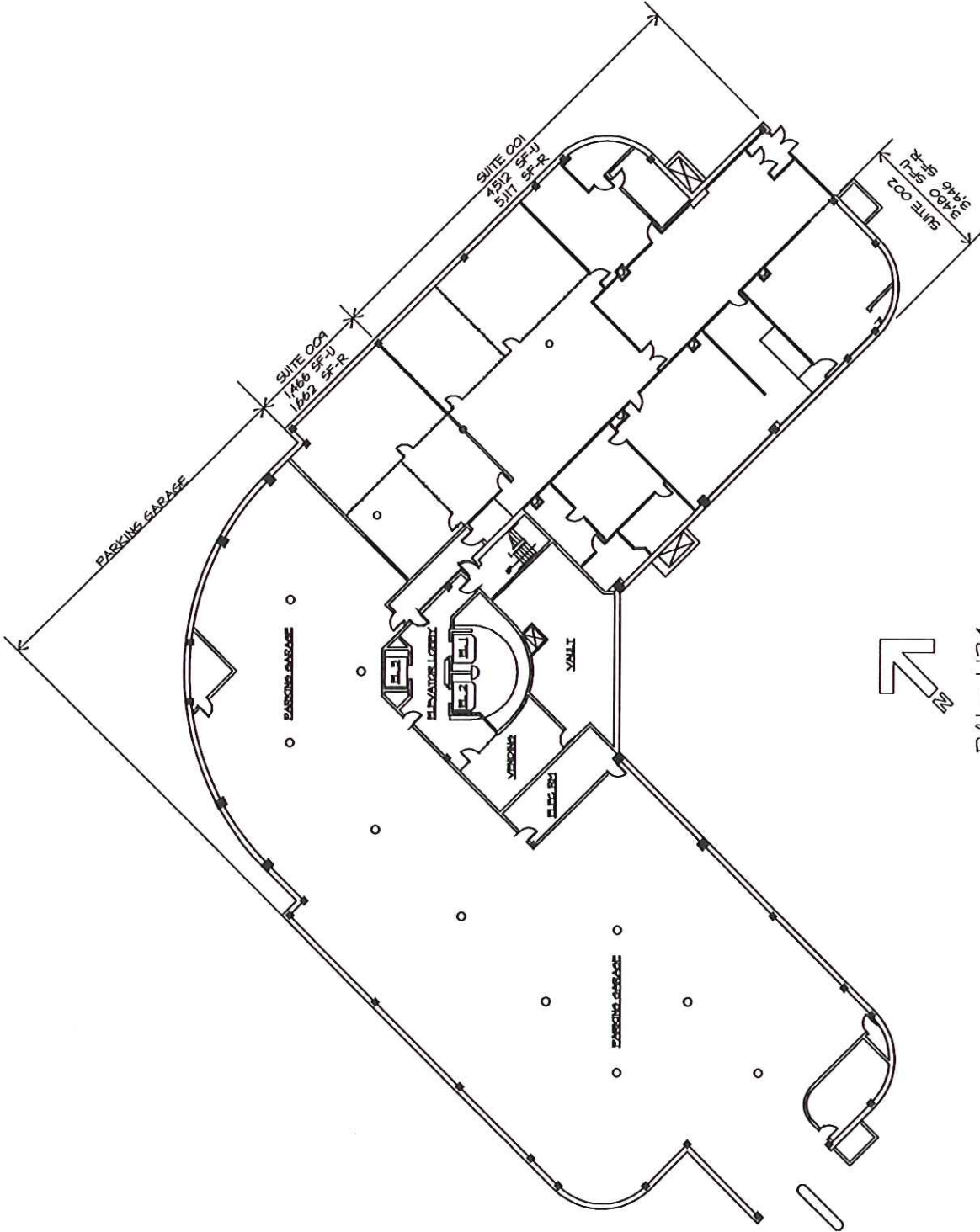

RU = 1.134

## SAND LAKE PLAZA - LOWER LEVEL

6450 POE AVE. DAYTON, OHIO 45414

SCALE 1" = 40' DATE REVISED 10-11-11

\* OCCUPIED SUITE

EXHIBIT "A"  
 FOR INFORMATION:  
 CREST COMMERCIAL REALTY  
 122 N. JEFFERSON STREET  
 DAYTON, OHIO 45402  
 PHONE: (937) 222-1600

UNIT NO.	TENANT	RENTABLE SQ. FT.	USABLE SQ. FT.
100	GSA	1,169	1,031
101	MINSTER BANK	967	853
102	VACANT	1,366	1,205
104	D. FRANKEL & ASSOC.	2,731	2,408
106	GROWTH RESOURCES	1,440	1,270
108	VACANT	811	715
109	VACANT	3,387	2,987
110	MARSTYS	1,987	1,752
111	STEEL SUMMIT	2,095	1,883
112	VACANT	979	863
114	VACANT	1,026	895
115	RAYMOND JAMES	1,534	1,353
116	XEROX	1,683	1,484
117	VACANT	364	321
118	VACANT	1,538	1,356
120	FUNDAMENTAL INSURANCE	917	809
121	COMMON EXERCISE ROOM	515	454
TOTAL		24,550	21,649

EXHIBIT "A"  
 FOR INFORMATION:  
 GREAT COMMERCIAL REALTY  
 122 N. JEFFERSON STREET  
 DAYTON, OHIO 45402  
 PHONE: (937) 222-1600

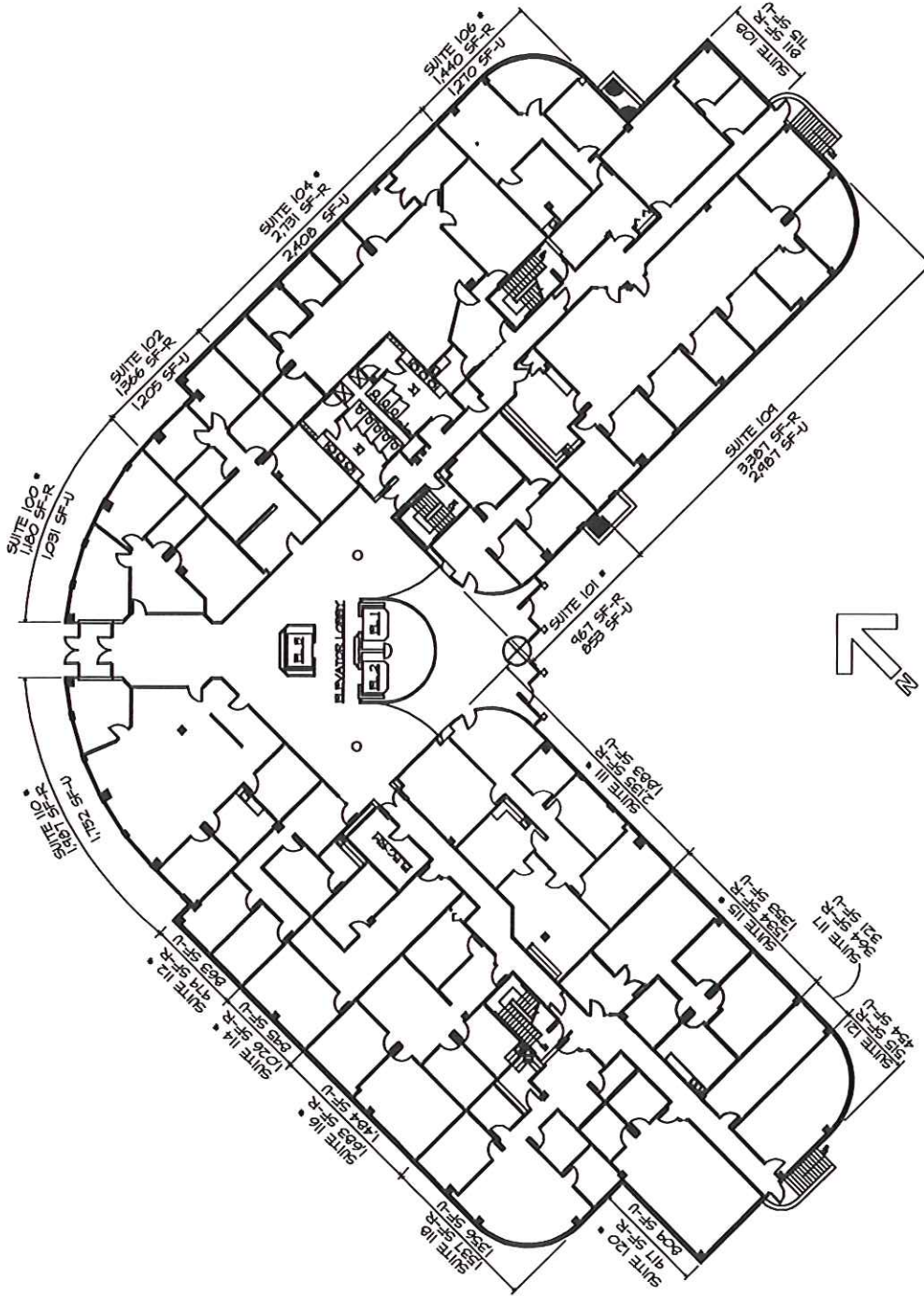

RU = 1.134

# SAND LAKE PLAZA - FIRST FLOOR

6450 POE AVE. DAYTON, OHIO 45414

SCALE 1" = 40' DATE REVISED 10-11-11

\* OCCUPIED SUITE

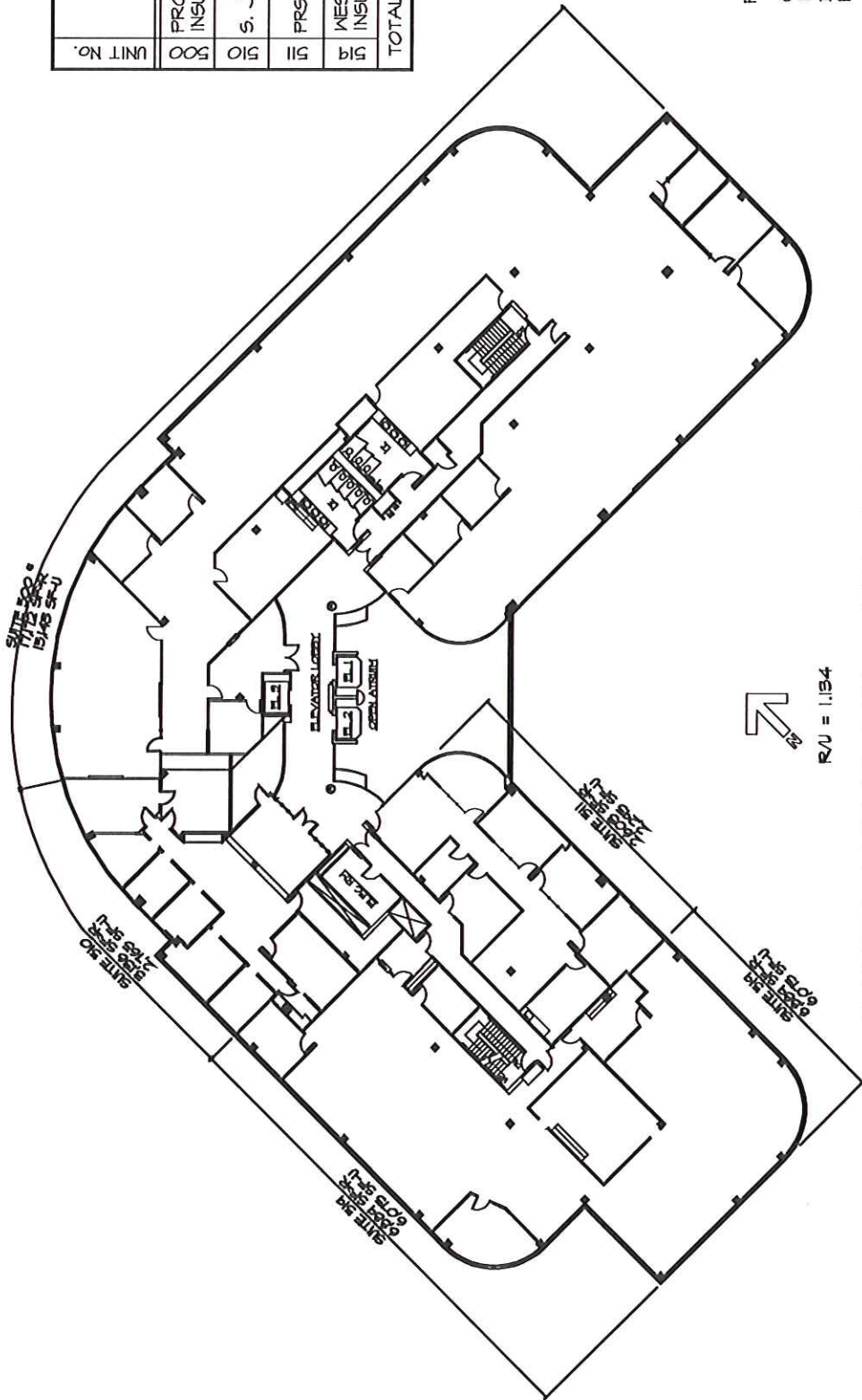

**SAND LAKE PLAZA - FIFTH FLOOR**

6450 POE AVE. DAYTON, OHIO 45414  
 SCALE 1" = 40' DATE REVISED 10-11-11  
 \* OCCUPIED SUITE

EXHIBIT "A"

FOR INFORMATION:

CREST COMMERCIAL REALTY  
 122 N. JEFFERSON STREET  
 DAYTON, OHIO 45402  
 PHONE: (937) 222-1600

UNIT No.	TENANT	RENTABLE SQ. FT.	USABLE SQ. FT.
500	PROGRESSIVE INSURANCE	17,172	15,143
510	S. J. WOLFE	3,136	2,765
511	FRS HOLDINGS	2,603	2,295
514	WESTFIELD INSURANCE	6,884	6,075
	TOTAL	26,664	23,513